

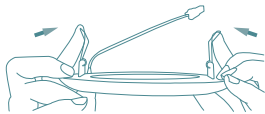

LED Down Light-Economic



- LED edge-lit technology, uniform light.
- Ultra-thin design with well heat dissipation structure, easy to use in narrow space.
- Anti-dripping in back side, anti-moist in front side, suitable for various interior space.
- Ideal replacement for traditional 26W CFL down light.



Move both spring buckles of the down light backward.

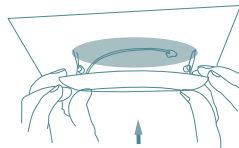

Insert both spring buckles into the cut-out hole and push the down light into position.



CRI : 80 ; Color Temperature : 5000K (4450K-5150K) / 4000K (3500K-4150K) / 3000K (2750K-3150K)

Model		ED060-11YR-3	
Dimension	Φ 180 x 31 mm (6")		
Power Consumption	10.9 w		
Color Temperature	5000K / 4000K	3000K	
Lumious Flux	860 lm	780 lm	
Illumination (1m)	440 lux	400 lux	
Illumination (2m)	110 lux	100 lux	
Power Factor	NO PFC		
Model		ED080-23YR-1	
Dimension	Φ 240 x 31 mm (8")		
Power Consumption	23.1 w		
Color Temperature	5000K / 4000K	3000K	
Lumious Flux	2050 lm	1850 lm	
Illumination (1m)	1080 lux	980 lux	
Illumination (2m)	270 lux	245 lux	
Power Factor	NO PFC		

- Y indicates Color Temperature of luminaire, B:3000K; D:4000K; F:5000K; J:5300K; G:5700K
- The above specification is the standard value, the company reserves the right to information revise.