

## Precautions



This luminaire is for indoor use only.



Input voltage must comply with the range as specified on the LED driver.



Operating temperature range : -20 °C ~ +40 °C  
Storage temperature range : -20 °C ~ +50 °C

- It is recommended that installation should be performed by professionals or certified electricians; and ensure that the power is turned off during installation, maintenance, and cleaning.
- Do not remove the warranty and manufacture labels, nor disassemble, repair, or modify the luminaire.
- Please ensure that the luminaire is complete and intact, and wires are not damaged nor broken before installation. In addition, please do not connect the luminaire with other electrical equipments in series.
- Please mind the sharp angles around the luminaire, and ensure that the luminaire is installed firmly to prevent it from falling and causing injuries.
- Wipe the luminaire gently by soft cloth without any solvent when performing cleaning tasks to prevent the luminaire's surface from scratching or damaging.
- Please use the original carton provided when performing storing and delivery tasks; don't drop or place heavy objects on it.

## Simple troubleshooting

Problem	Possible causes	Troubleshooting
Luminaire fails to light up.	<ul style="list-style-type: none"> <li>▶ Power is not on.</li> <li>▶ Power cord is not properly connected.</li> <li>▶ Luminaire or LED driver malfunction.</li> </ul>	<ul style="list-style-type: none"> <li>Switch on the power.</li> <li>Ensure all wires are properly connected.</li> <li>Please contact the distributor for customer service.</li> </ul>
Luminaire lights does not light up at all.	<ul style="list-style-type: none"> <li>▶ LED light source malfunction.</li> </ul>	<ul style="list-style-type: none"> <li>Please contact the distributor for customer service.</li> </ul>

## Warranty

- Service: Under normal usage, if the product is found to be defective within its warranty period, please send the product and the receipt back for repair.
- The warranty is void if :
  - Incorrect voltage was applied to the product, or the product was installed improperly, or used in abnormal environment / under abnormal usage, or its precautions were not followed.
  - The product did not use the dedicated LED driver provided by us.
  - The product is repaired, modified, or altered in any way; or, the warranty and the manufacture labels were removed, damaged, or unrecognizable.
  - The failure was caused by the buyer's misbehavior or carelessness during transportation, delivery, or storage process after purchasing.
  - The failure was caused by natural disasters such as earthquake, or nibbles by mice or bugs etc.
  - The product was used or operated under special and harsh environments; for example, damp or sulphuric area, seashore area, or on the ship, or other corrosive and erosive environments.
- For further information regarding the product, please refer to our website or contact customer service.

## Luminaire accessories and Anchor allocation position

Type	dimension
epoSmiley™C type	1230mm x 100mm x 41.2mm
epoSmiley™U type	1234mm x 85mm x 48mm

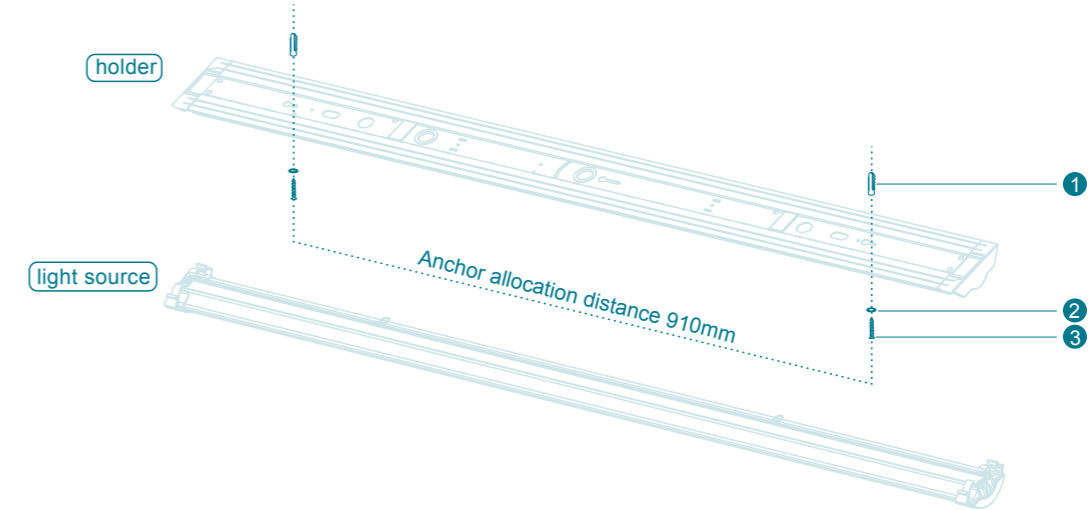

### Accessories for Surface-Mounted type

- ① Anchor x 2
- ② Washer x 2
- ③ Self-tapping screw x 2 (Applicable for solid wooden panels or wooden angle bars that are above 20mm thick, or solid cement walls and brick walls)
- ④ Close end connector x 3

### Accessories for Corner Installation (Only for U-type, additional purchase)

- ① Anchor x 4
- ② Washer x 4
- ③ Self-tapping screw x 2 (Applicable for solid wooden panels or wooden angle bars that are above 20mm thick, or solid cement walls and brick walls)
- ④ T-accessory x 1
- ⑤ Wing nut x 1
- ⑥ Carriage bolt x 1
- ⑦ Machine Screw x 1

## Hole on luminaire diagram

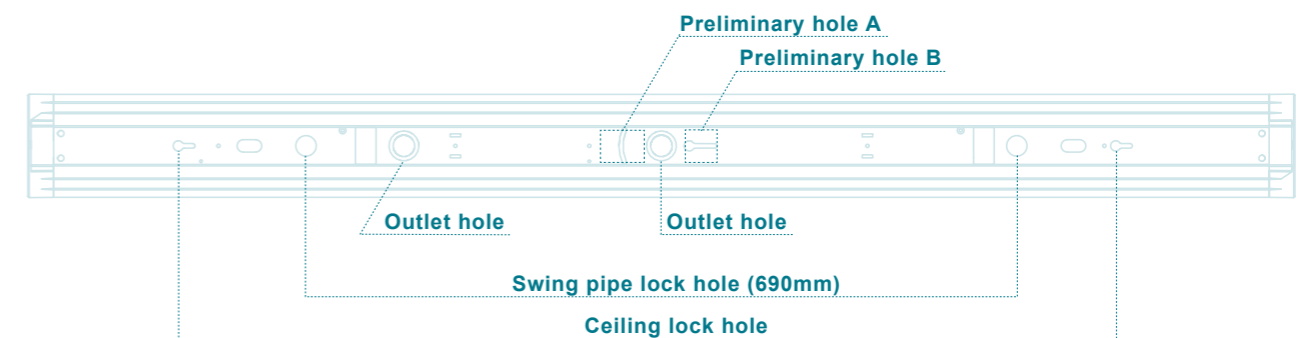

## Mounted installation guide

### Luminaire position

**⚠** Before allocating luminaire, pass the in-house power cord through the outlet hole of the luminaire for preparing wiring.

- 1** Pull the in-house power cord and pass it through the outlet hole of the holder.

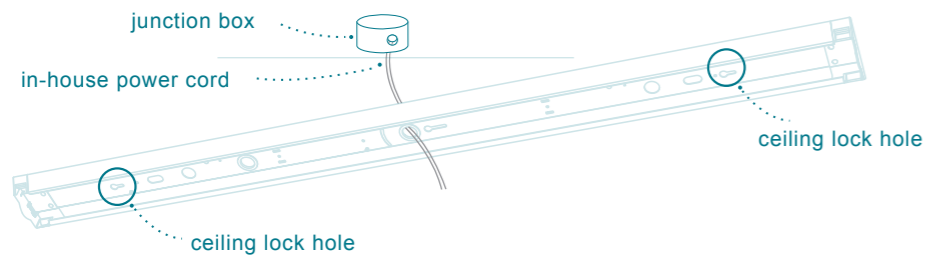

- 2** Fix the holder onto the ceiling.

- a** Referring to the diagram of "Hole on luminaire", drill the hole to fix the two anchors, and screw the self-tapping screws and washers half into the two anchors.  
**b** Align "the two ceiling lock hole" of the luminaire and "two half-screwed self-tapping screws", and push the luminaire up.  
**c** Move the luminaire to be latched by the ceiling lock hole of the luminaire.  
**d** After latching with the ceiling lock hole, screw the other half of self-tapping screws, and finish the luminaire allocation.

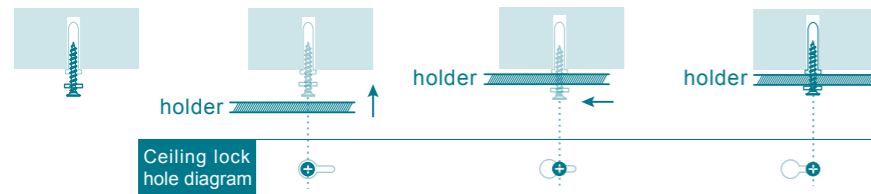

### Wiring luminaire with AC power cord

- 3** Connect the in-house AC power cord with driver's AC side.

**⚠** The close end connector applies to 18AWG AC power cord.

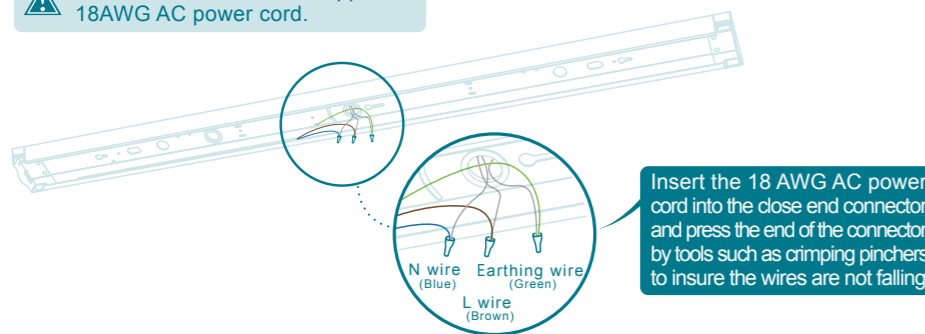

- 4** Insert the wires into the wire clip in holder's side.

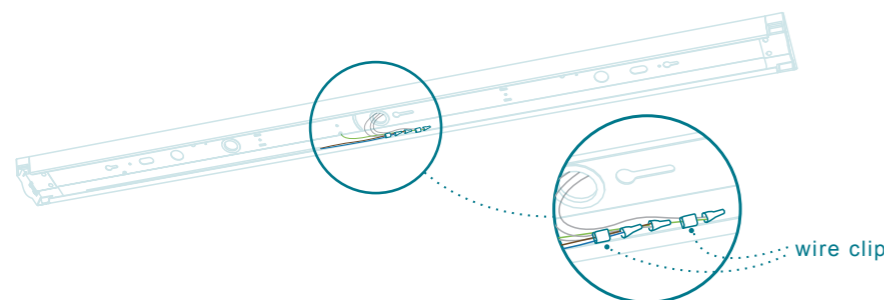

### Hang up the light source temporarily

- 5** Hang up the rings of the light source onto the holder's accessory hook.

**⚠** This step is aim to wiring preparation, not for suspended function.

- 6** Use tools to press the accessory hook.

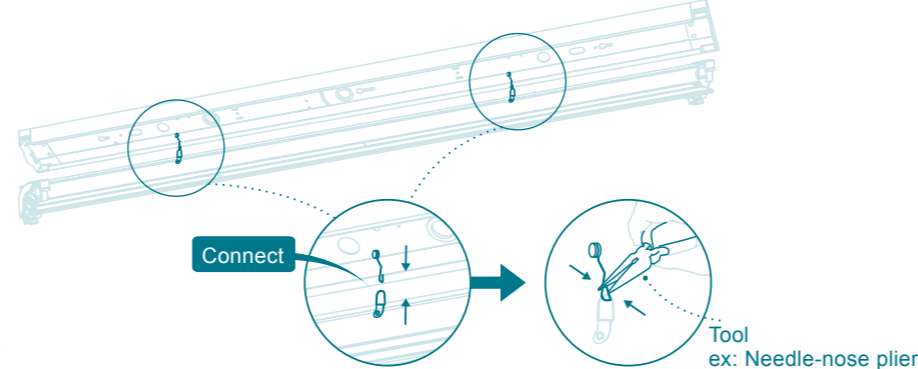

### Connect light source with driver's DC side

- 7** Connect light source with driver's DC side connector.

- 8** Arrange the wires and insert to the wire clip in holder.

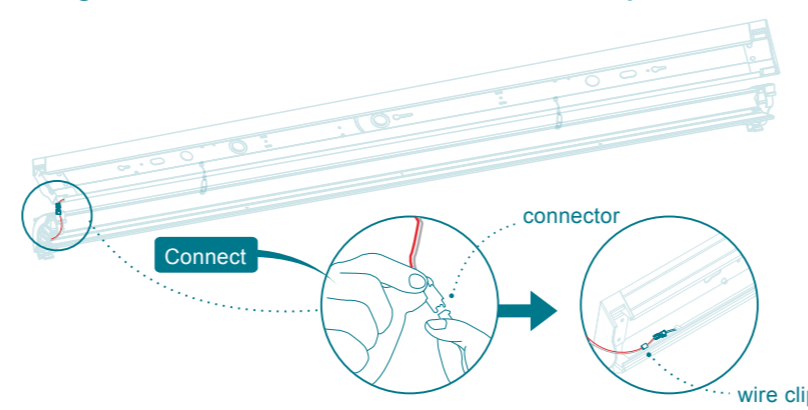

**⚠** Only connect with the dedicated light source as epoSmiley™ series.

### Buckle the light source with holder

- 9** Buckle up the light source's two end caps with holder.

- 10** Push the middle of the light source until hearing a click sound, then finishing the installation.

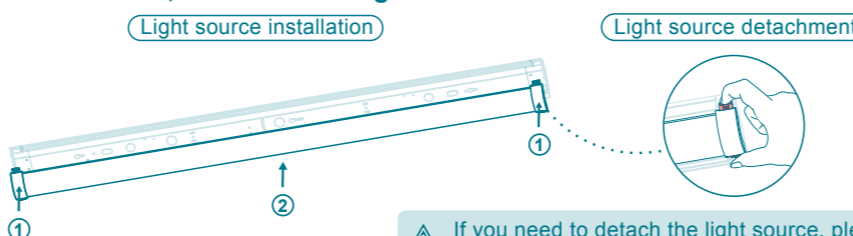

**⚠** If you need to detach the light source, please press light source's two end caps where marks the "press".

## Right angle installaiton guide

### Mounted T-accessory installation

**⚠** Only for U type. Right angle accessory need to be bought in additional.

#### Allocation distance of T-accessory

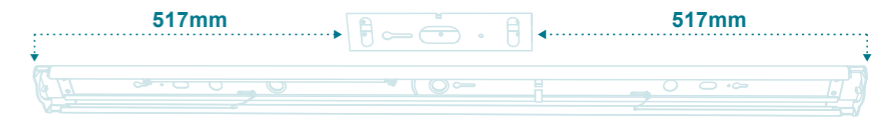

- 1** Fasten the T-accessory with self-tapping screws. (Use anchors and washers on concrete ceiling, take "Mounted installation guide" step 2 for reference.)  
**2** Pass the in-house power cord through the T-accessory and pull it from the outlet hole.

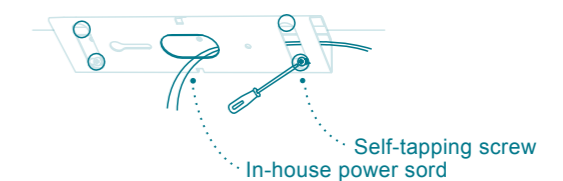

### Mounted holder installation

- 3** Fasten the wing nut and carriage bolt on the holder's Preliminary hole A.

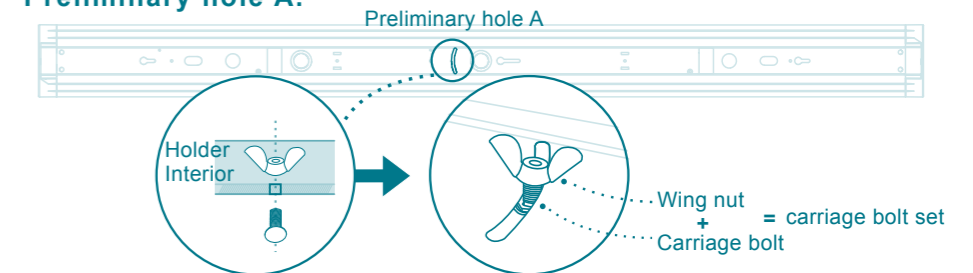

- 4** Pass the in-house power cord through the outlet hole of the holder. Put the carriage bolt set to T-accessory's ceiling lock hole a.

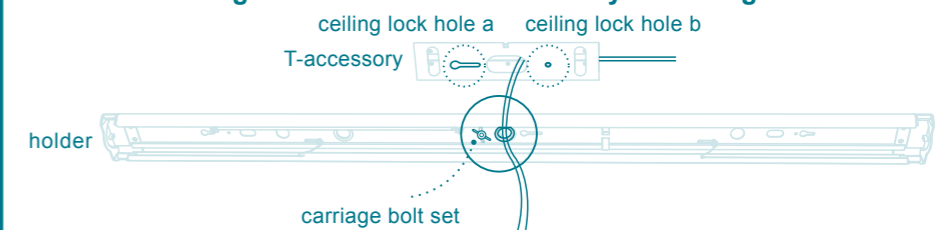

- 5** Adjust the holder and T-accessory location by carriage bolt set and ceiling lock hole a, then, fasten the holder and T-accessory with machine screw on holder's ceiling lock hole B and T-accessory's ceiling lock hole b.

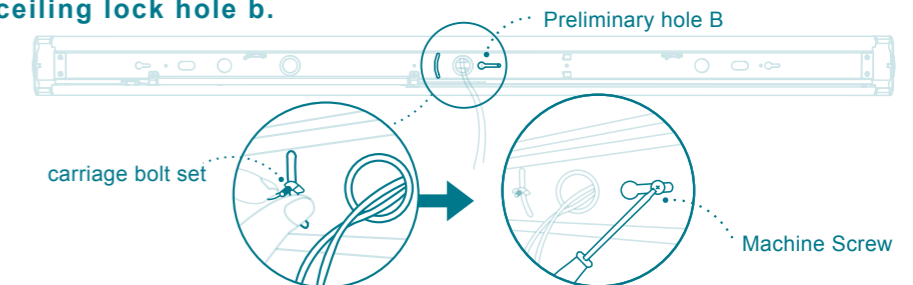

- 6** For the wiring installation and light source installation, take "Mounted installation guide" step 3 to step 10 for reference.